

Colorado Allergy and Anaphylaxis Emergency Care Plan and Medication Orders

Student's Name: _____ D.O.B. _____ Grade: _____

School: _____ Teacher: _____

ALLERGY TO: _____

HISTORY: _____

Place child's
photo here

Asthma: ☐ YES (higher risk for severe reaction) – refer to their asthma care plan

☐ NO

◇ STEP 1: TREATMENT

SEVERE SYMPTOMS: Any of the following:

LUNG: Short of breath, wheeze, repetitive cough
THROAT: Tight, hoarse, trouble breathing/swallowing
MOUTH: Swelling of the tongue and/or lips
HEART: Pale, blue, faint, weak pulse, dizzy
SKIN: Many hives over body, widespread redness
GUT: Vomiting or diarrhea (if severe or combined with other symptoms)
OTHER: Feeling something bad is about to happen, Confusion, agitation

MILD SYMPTOMS ONLY:

NOSE: Itchy, runny nose, sneezing
SKIN: A few hives, mild itch
GUT: Mild nausea/discomfort

1. INJECT EPINEPHRINE IMMEDIATELY

2. Call 911

- Ask for ambulance with epinephrine
- Tell EMS when epinephrine was given

3. Stay with child and

- Call parent/guardian and school nurse
- If symptoms don't improve or worsen give second dose of epi if available as instructed below
- Monitor student; keep them lying down. If vomiting or difficulty breathing, put student on side

Give other medicine, if prescribed. (see below for orders) Do not use other medicine in place of epinephrine. **USE EPINEPHRINE**

1. Stay with child and

- Alert parent and school nurse
- Give antihistamine (if prescribed)

2. If two or more mild symptoms present or symptoms progress **GIVE EPINEPHRINE** and follow directions in above box

DOSAGE: Epinephrine: inject intramuscularly using auto injector (check one): ☐ 0.3 mg ☐ 0.15 mg

☐ If symptoms do not improve ____ minutes or more, or symptoms return, 2nd dose of epinephrine should be given if available

Antihistamine: (brand and dose) _____

Asthma Rescue Inhaler (brand and dose) _____

Student has been instructed and is capable of carrying and self-administering own medication. ☐ Yes ☐ No

Provider (print) _____ Phone Number: _____

Provider's Signature: _____ Date: _____

◇ STEP 2: EMERGENCY CALLS ◇

1. If epinephrine given, **call 911**. State that an anaphylactic reaction has been treated and additional epinephrine, oxygen, or other medications may be needed.

2. Parent: _____ Phone Number: _____

3. Emergency contacts: Name/Relationship _____ Phone Number(s) _____

a. _____ 1) _____ 2) _____

b. _____ 1) _____ 2) _____

DO NOT HESITATE TO ADMINISTER EMERGENCY MEDICATIONS

I give permission for school personnel to share this information, follow this plan, administer medication and care for my child and, if necessary, contact our health care provider. I assume full responsibility for providing the school with prescribed medication and delivery/monitoring devices and release the school and personnel from any liability in compliance with their Board of Education policies.

Parent/Guardian's Signature: _____ Date: _____

School Nurse: _____ Date: _____

To be completed by healthcare provider

Student Name: _____ DOB: _____

Staff trained and delegated to administer emergency medications in this plan:

1. _____ Room _____

2. _____ Room _____

3. _____ Room _____

Self-carry contract on file: ☐ Yes ☐ No

Expiration date of epinephrine auto injector: _____

Keep the child lying on their back. If the child vomits or has trouble breathing, place child on his/her side.

AUVI-Q™ (EPINEPHRINE INJECTION, USP) DIRECTIONS

1. Remove the outer case of Auvi-Q. This will automatically activate the voice instructions.
2. Pull off red safety guard.
3. Place black end against mid-outer thigh.
4. Press firmly and hold for 5 seconds.
5. Remove from thigh.

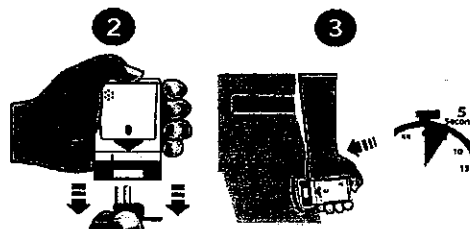

ADRENALINE® (EPINEPHRINE INJECTION, USP) AUTO-INJECTOR DIRECTIONS

1. Remove the outer case.
2. Remove grey caps labeled "1" and "2".
3. Place red rounded tip against mid-outer thigh.
4. Press down hard until needle enters thigh.
5. Hold in place for 10 seconds. Remove from thigh.



EPIPEN® AUTO-INJECTOR DIRECTIONS

1. Remove the EpiPen Auto-Injector from the clear carrier tube.
2. Remove the blue safety release by pulling straight up without bending or twisting it.
3. Swing and firmly push orange tip against mid-outer thigh until it 'clicks'.
4. Hold firmly in place for 3 seconds (count slowly 1, 2, 3).
5. Remove auto-injector from the thigh and massage the injection area for 10 seconds.

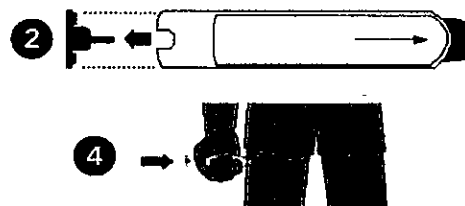

If this conditions warrents meal accomodations from food service, please complete the form for dietary disability if required by district policy.

Additional information: _____

Adopted from the Allergy and Anaphylaxis Emergency Plan provided by the American Academy of Pediatrics, 2017